



Moisture
Management
for Masonry

326 Melton Rd., Burns Harbor, IN 46304
P 800 664 6638 F 219 787 5088
www.mortarnet.com

WallDefender™

This package contains 100 LF of 1" or 2" **WallDefender™**

General Information

1. Fast and easy to use - no fasteners or adhesives, no special skills or tools. After the first one to two courses of bricks are laid, place a continuous row of WallDefender in the cavity or collar joint on flashing (trapezoidal side up) against inside of outer wythe at base of wall.
2. Install WallDefender directly on flashing at base of wall, over all wall openings, shelf angles, sills or lintels.
3. Install WallDefender at every floor level. For wall-cavities that exceed 11' in height, place an additional continuous trapezoidal strip on wall reinforcing anchors/ties at every 9' to 11' of wall height.
4. Flashing should extend from bottom to 6" above the top of WallDefender, as should any other materials used to fill space between the WallDefender and inside cavity surface.
5. No more than 1/4" should be left between WallDefender and cavity's inside surface (flashing or filler). WallDefender is compressible to allow for variations in wall-cavity widths.

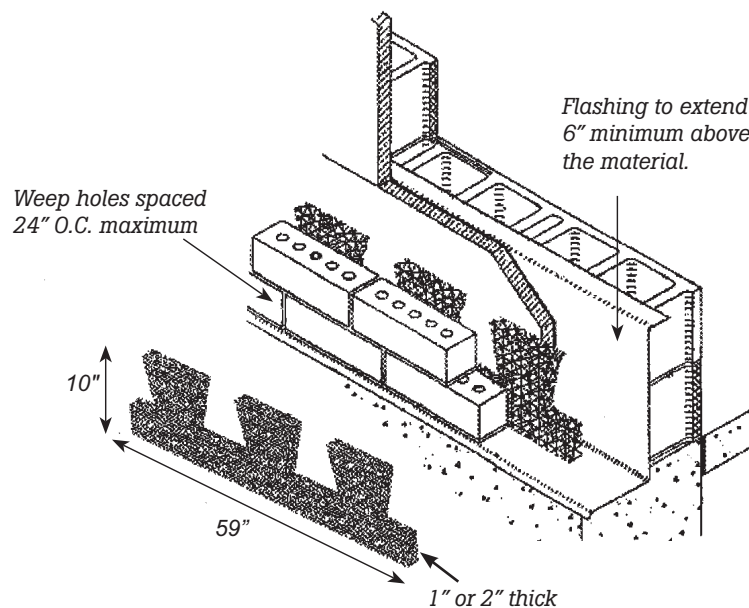

WallDefender should be installed only by experienced masons in properly specified weep hole/flashing systems.